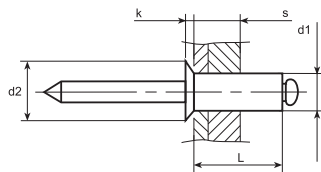

DIN 7337-A**Remaches con cabeza avellanada**

ISO EN

d1	3	3,2	4,0	4,8	5,0	
d2	6	6	7,5	9	9	
k	0,90	0,9	1	1,20	1,2	
ø Taladro	3	3,3	4,1	4,90	4,9	
L	(6-14,16)	(6-12,15,18)	(6-14,16-20)	(6-14,16-18,21-24,27-30)	(6-14,16-20,25,30)	
ST/ST ●	AL/ST ●	AL/AL ●	A2/A2 ●	CU/ST ●	AL/A2 ●	A4/A4 ●